



Project \_\_\_\_\_

Item No. \_\_\_\_\_

Quantity \_\_\_\_\_

## GAS STEAM KETTLE- FLOOR BASE & LEGS

Model IGC-12 12 gallon (45 litre) gas tilting floor model kettle

### CONSTRUCTION

- Water resistant construction
- 304 stainless steel construction
- 316 stainless steel interior cooking surface for added corrosion resistance
- 2/3 jacketed with factory sealed distilled water enclosure
- Hemispherical design on bottom of kettle for superior heat circulation
- Stainless steel control housing
- Four stainless steel tubular legs fitted with a four hole adjustable foot for securing the unit to the floor

### OPERATION

- Gas self-generated closed steam system
- Electronic ignition
- Integrally mounted controls
- Power switch
- Thermostat
- Cook indicator light
- Ignition light
- Pressure gauge
- Water sight glass
- Safety valve
- Low water light
- Low water shut off
- 150-285°F (60-140°C) temperature range
- 50 PSI maximum pressure

### STANDARD FEATURES

- Removable operating handle with heat proof knob
- "Clean Lock" holds kettle in cooking position or 105° for ease of cleaning
- Manual control
- 120 VAC, 1 phase, 60 Hz
- One year parts and labor warranty



IGC | GAS STEAM KETTLE- FLOOR BASE & LEGS

### OPTIONS AND ACCESSORIES

(AT ADDITIONAL CHARGE)

#### Faucets

- Single pantry faucet with swing spout
- Double pantry faucet with swing spout

#### Etched markings

- Gallons
- Litres

One piece stainless steel lift off cover

Stainless steel perforated basket

220 VAC, 1 phase, 50/60 Hz



# IGC | GAS STEAM KETTLE- FLOOR BASE & LEGS

## MAXIMUM INPUT:

IGC-12            43,000 BTU

## POWER CONNECTION:

Unless otherwise specified, electrical connection to be 120 VAC, 2 amp, 1 phase, 60 Hz, with grounding wire. Unit furnished with 6' cord and 3 prong plug.

## GAS SUPPLY:

3/4" pipe

### Minimum Inlet Pressure:

Natural    6.0" W.C. static to unit  
Propane   12.0" W.C. static to unit

## MAXIMUM PRESSURE:

50 PSI (345 kPa)

## SHORT FORM SPECIFICATIONS

Provide Intek model IGC-12 (12 gallon) gas fired floor model tilting kettle. The controls shall be integrally mounted, and shall include a power switch, electronic ignition, thermostat with range of 150-285°F (66-140°C), a cook indicator light, pressure gauge, safety valve, low water light and low water shut off. The burners shall turn off automatically when the kettle is tilted. The unit shall have a double wall interior to form a steam jacket around the lower 2/3 of the kettle. The jacket enclosure shall contain distilled water which is factory sealed. The bottom of the kettle shall be of hemispherical design for superior heat circulation. The unit shall include four stainless steel tubular legs fitted with a four hole adjustable foot for securing the unit to the floor. The unit shall have a removable operating handle with heat proof knob mounted on the right. Construction shall be of all welded #4 finish 304 stainless steel. The interior cooking surface shall be 316 stainless steel. Unit shall be ASME code stamped and National Board registered. Provide options and accessories as indicated.

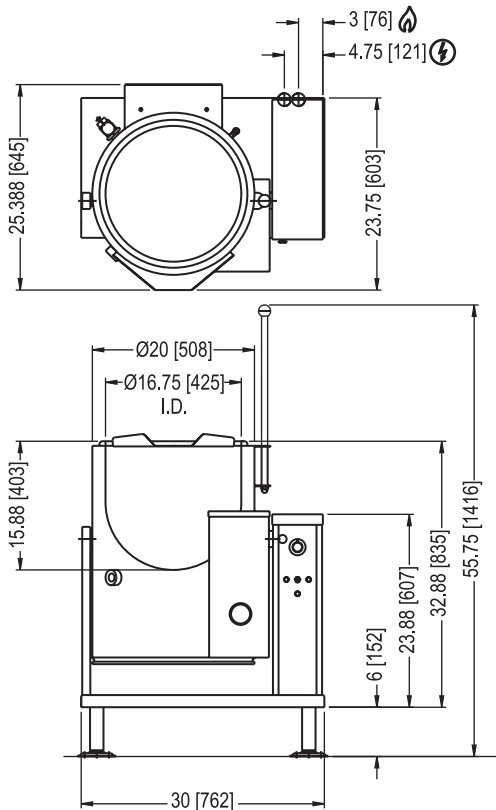

### FLANGED FOOT DETAIL

4 EQUALLY SPACED  
Ø7/16" [11mm] HOLES  
ON 3 [76] B.C.

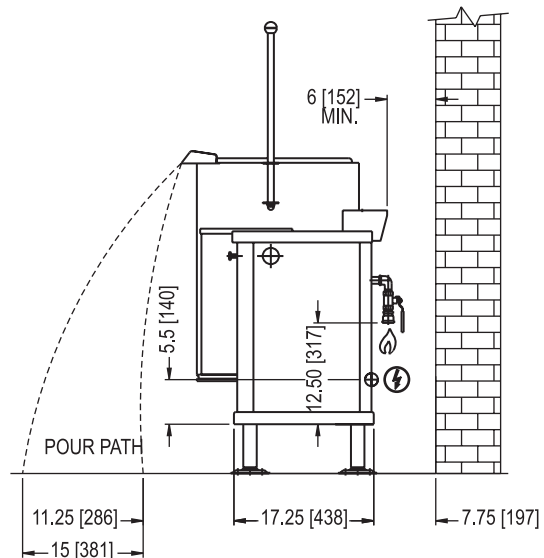

DIMENSIONS ARE IN INCHES [MM]